



£550,000

20 St. Andrews Road, Montpelier, Bristol, BS6 5EH

2 The Promenade, Bristol, BS7 8AL

Tel: 0117 3700556

Email: info@elephantlovesbristol.co.uk

Web: www.elephantlovesbristol.co.uk

20 St. Andrews Road Montpelier, Bristol, BS6 5EH

A fine example of a Victorian family home located on St Andrews Road in Montpelier. Situated within a short walk to Montpelier train station, this property has a lot to offer with its great views over the city, original features and scope to extend further.

Ground floor accommodation comprises two open plan living rooms with stripped wood floors. The front reception room has a bay window with new double-glazed uPVC sash windows, ornate ceiling cornice and rose, stripped wood floor and a period fireplace. The rear of the two reception rooms feels light and bright and features ceiling coving and a new uPVC double-glazed sash window overlooking the rear garden.

At the rear of the ground floor is a stylish kitchen/diner complete with a range of contemporary wall and base units with solid wood worktops, tiled splash-backs and terracotta tiled floor. This space is filled with natural light thanks to two large windows and a glazed door leading out onto the rear garden.

On the first floor are three bedrooms and a family bathroom. The main bedroom is at



the front and spans the full width of the property with a picture rail, period fireplace and fitted period wardrobe. This room further benefits from a pleasant and open outlook onto the park adjacent and neighbouring houses. Next door is the second double bedroom which also has a period fireplace, whilst the third bedroom is at the rear of the property and is currently being used as a study.

Externally, the front of the property possesses the classic Victorian facade with double bay frontage, whilst the pleasant and sunny rear garden is presented in two sections: a small paved patio area with steps leading up to a lawned garden with a seating area to catch the last of the afternoon sun. The house further benefits from 9 solar panels on the roof.

This lovely property is the epitome of a Montpelier home that has been lovingly updated by the current owner and a desirable central location with easy access to the many local cafes, bars, restaurants and shops.





20 Saint Andrews Road, Bristol, BS6 5EH

Approximate Gross Internal Area = 96.7 sq m / 1041 sq ft

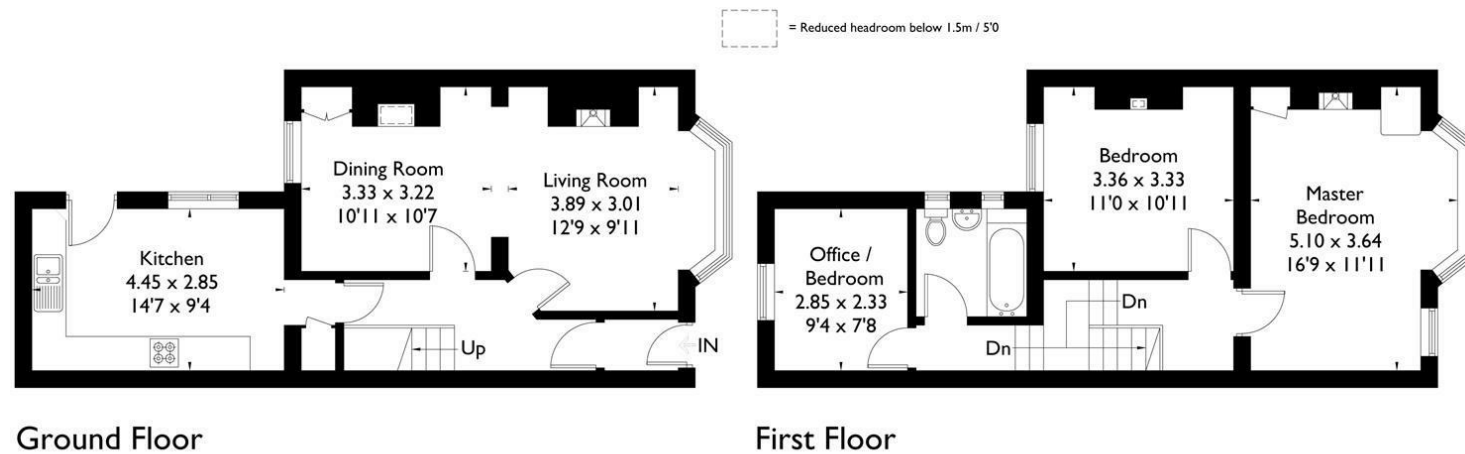

Ground Floor

First Floor

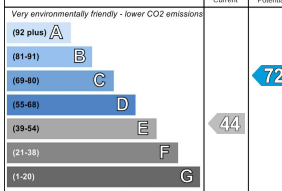
Energy Efficiency Rating		Environmental Impact (CO ₂) Rating	
Current	Potential	Current	Potential
 <p>Very energy efficient - lower running costs</p> <p>(92 plus) A</p> <p>(81-91) B</p> <p>(69-80) C</p> <p>(55-68) D</p> <p>(39-54) E</p> <p>(21-38) F</p> <p>(1-20) G</p> <p>Not energy efficient - higher running costs</p>	<p>77</p>	 <p>Very environmentally friendly - lower CO₂ emissions</p> <p>(82 plus) A</p> <p>(61-81) B</p> <p>(49-60) C</p> <p>(35-48) D</p> <p>(29-54) E</p> <p>(21-38) F</p> <p>(1-20) G</p> <p>Not environmentally friendly - higher CO₂ emissions</p>	<p>72</p>
<p>England & Wales</p> <p>EU Directive 2002/91/EC</p>	<p>England & Wales</p> <p>EU Directive 2002/91/EC</p>	<p>England & Wales</p> <p>EU Directive 2002/91/EC</p>	<p>England & Wales</p> <p>EU Directive 2002/91/EC</p>

FLOORPLANZ © 2018 0203 9056099 Ref: 223957

This plan is for layout guidance only. Drawn in accordance with RICS guidelines. Not drawn to scale unless stated. Windows & door openings are approximate. Whilst every care is taken in the preparation of this plan, please check all dimensions, shapes & compass bearings before making any decisions reliant upon them.

Disclaimer: You may download, store and use the material for your own personal use and research. You may not republish, retransmit, redistribute or otherwise make the material available to any party or make the same available on any website, online service or bulletin board of your own or of any other party or make the same available in hard copy or in any other media without the website owner's express prior written consent. The website owner's copyright must remain on all reproductions of material taken from this website.